

NEXUS™ 200

Operating Manual

INSTRUCTIONS FOR CONCRETE FIXING KIT (INTO PREPARED CONCRETE FOUNDATION)

IMPORTANT NOTE: TO ENSURE A SECURE AND ROBUST INSTALLATION THE BIN SHOULD BE SITED ONTO A SOUND CONCRETE FOUNDATION AND THE 50MM DIAMETER WASHER MUST BE USED. WE STRONGLY RECOMMEND THAT THE BIN IS **NOT** INSTALLED ONTO TARMAC OR BLOCK PAVED AREAS.

DISTANCE FROM EDGE OF FOUNDATION TO CENTRE OF GROUND BOLT TO BE NO LESS THAN 110MM

Permanently sited onto a prepared concrete ground site (20-30N/mmsq) utilising 6 M10x120mm ground fixing bolts which are supplied with your bin.

- 1) Position bin onto siting area ensuring it is the correct distance away from the edge of the concrete (minimum 110mm) and is in the correct orientation with regard to the apertures.
- 2) From the inside of the bin mark hole positions onto the concrete through the fixing holes in the base of the bin with a 12mm diameter masonry drill. Remove the bin.
- 3) Using a 12mm diameter masonry drill bit, drill and clean out anchor holes to a minimum depth of 130mm. Position bin back over the drilled holes.
- 4) Assemble the ground bolts as shown in diagram opposite by removing the 20mm washer and replacing it with the 50mm washer. Drive the ground bolts through the holes in the base of the bin and into the holes in the concrete.
- 5) Tighten nut with correct spanner until fixings are secure. Max recommended torque setting - 20lbs/ft (27Nm).
- 6) In the event of the bin being removed, simply remove the bolt to leave the site hazard free.

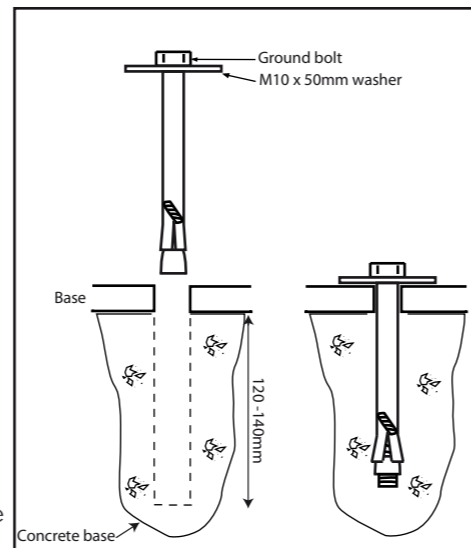

NOTE: For alternative fixing methods please contact us for details.

Cleaning Your Bin

We would recommend a warm pressure wash with soap or alternatively hand wash with 10% solution of mild detergent in warm water using a soft bristle brush followed by a rinse with clean water.

Graffiti

Felt tip pen or paint may be removed from Durapol using a proprietary graffiti remover. Carefully follow the instructions, particularly the guidelines covering safety. Ensure that all traces of chemicals are removed then clean as detailed above.

CAUTION:

Graffiti removers can damage stickers, some protection may be afforded by masking off such areas. Please refer to Technical Services for our recommended graffiti removal supplier.

Maintenance

A planned maintenance schedule of regular inspection is recommended and components replaced when necessary.

 AND NEXUS™ 200 ARE TRADEMARKS OF GLASDON GROUP OR ITS SUBSIDIARIES IN THE U.K. AND OTHER COUNTRIES

- A planned maintenance schedule of regular inspection is recommended, replacing components as necessary.
- Replacement components are available direct from GLASDON UK LIMITED.
- GLASDON UK LIMITED cannot be held responsible for claims arising from incorrect installation, unauthorised modifications or misuse of the product.

Issue 1 June 2010 C000/0361
© Copyright 2010
Glasdon UK Ltd reserve the right to alter specifications without prior notice.

 **Glasdon**
Glasdon U.K. Limited

Preston New Road
BLACKPOOL
Lancashire FY4 4UL
Tel: 01253 600410
Fax: 01253 792558
email: sales@glasdon-uk.co.uk
web: www.glasdon.com

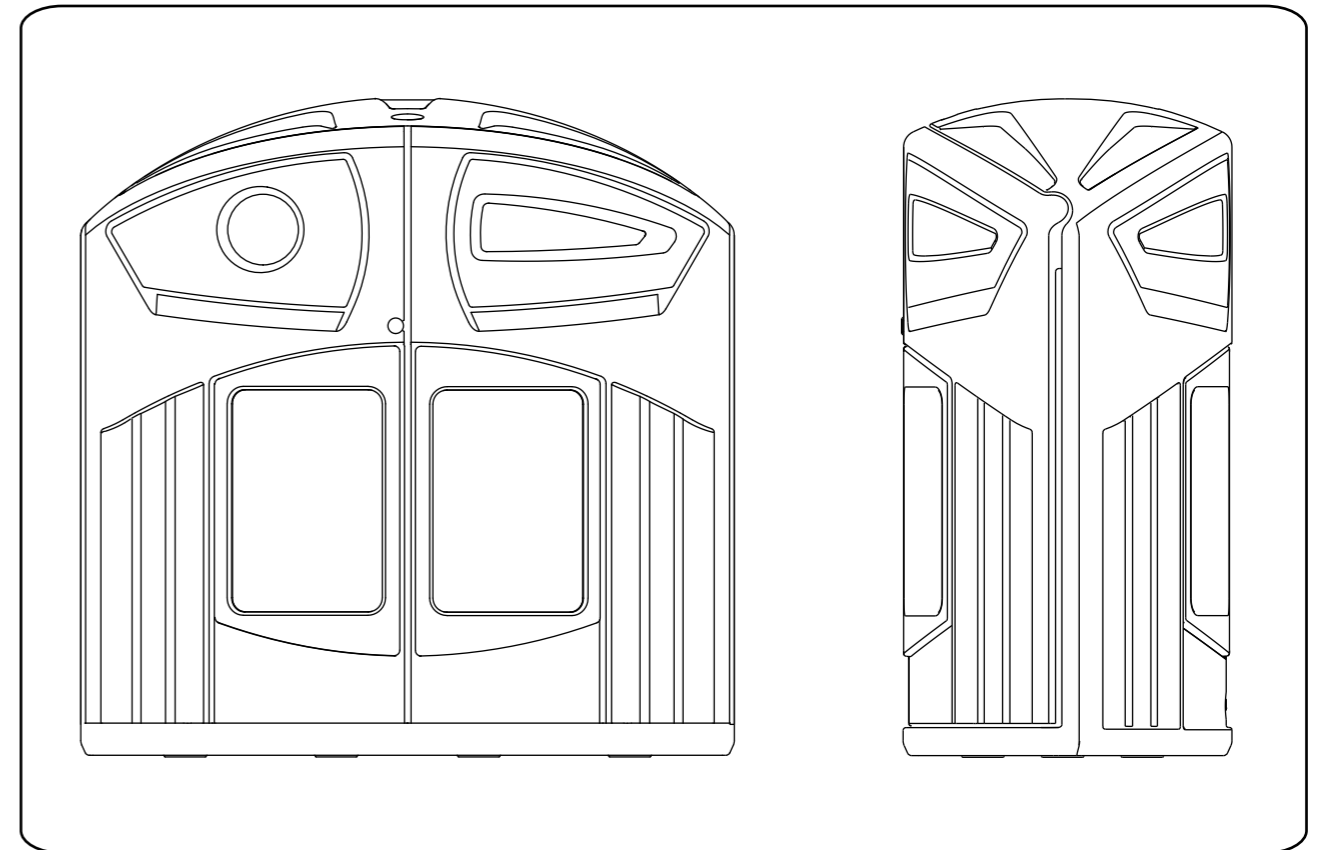

NEXUS™ 200

Operating Manual



IMPORTANT NOTE:
THE BIN MUST BE SITED ON LEVEL GROUND TO ENSURE CORRECT ALIGNMENT OF THE DOOR AND BODY. IF YOU ARE NOT USING GLASDON FIXINGS YOU MUST ENSURE THAT 50MM DIAMETER WASHERS ARE USED IN ORDER TO SECURE THE BIN WHEN GROUND FIXING.



NOTE: ENSURE THAT ALL RELEVANT PERSONNEL READ THE POINTS LISTED WITHIN THIS LEAFLET AND THAT A COPY IS GIVEN TO STAFF INVOLVED WITH THE INSTALLATION AND MAINTENANCE OF THIS PRODUCT

NEXUS™ 200

Operating Manual

Opening Bin

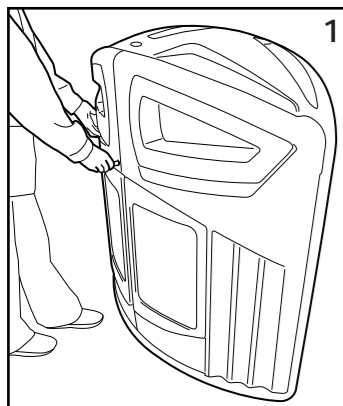

1 Insert key into key hole and place hand into recess under aperture on the left hand door (as shown above).

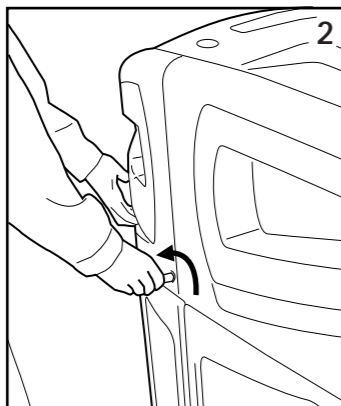

2 Turn key anticlockwise until it stops.

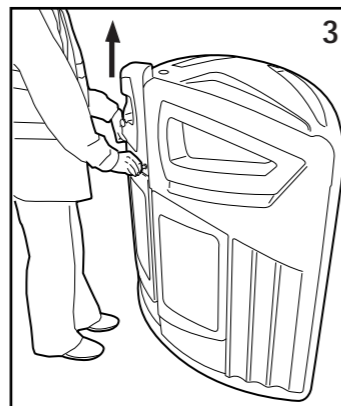

3 Using handle recess lift the left hand door and allow door to pivot open.

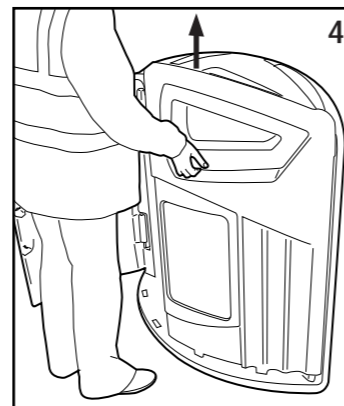

4 Using handle recess on right hand door, lift and allow door to pivot open.

Removing Liners/Using Sack Retention

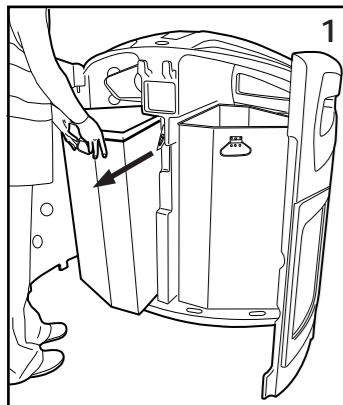

1 Remove liner by sliding out of bin.

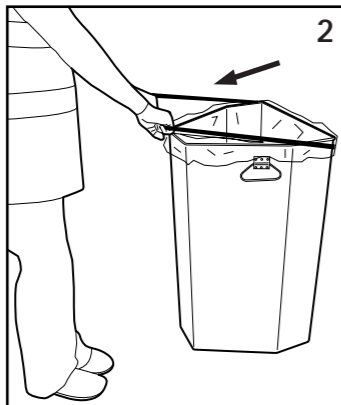

2 Insert plastic sack and reposition elasticated sack band to secure plastic sack.

Closing Bin

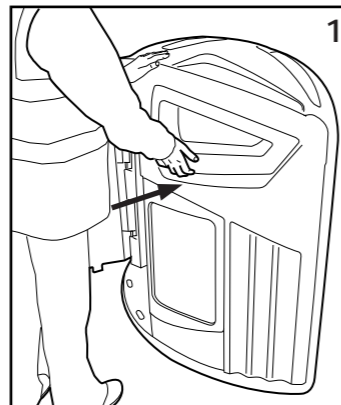

1 To lock the bin, slam shut right hand door first.

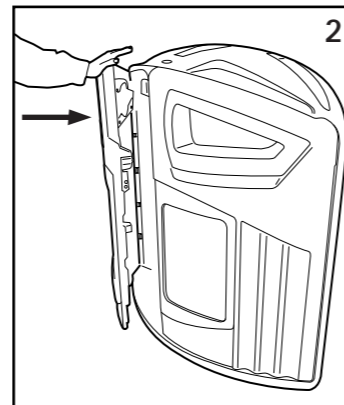

2 Then slam shut left hand door.

Inserting/Removing Posters (Accepts laminated A3 paper/card with a visible viewing area of 350 mm x 267 mm)

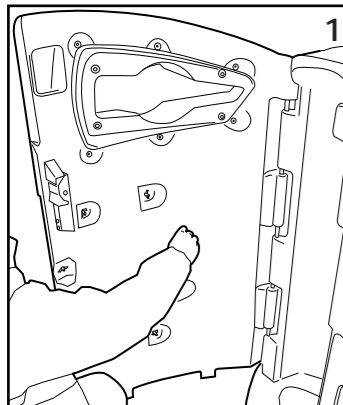

1 Open doors and remove all eight wingnuts and washers by unscrewing anticlockwise.

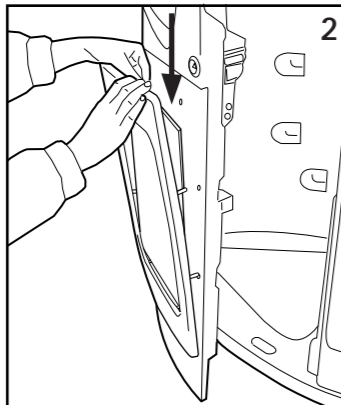

2 From outside the bin, remove the frame and insert/replace poster behind the clear panel.

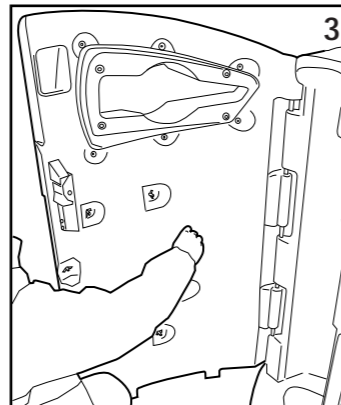

3 Place frame back into position and tighten wingnuts from inside the bin to secure.

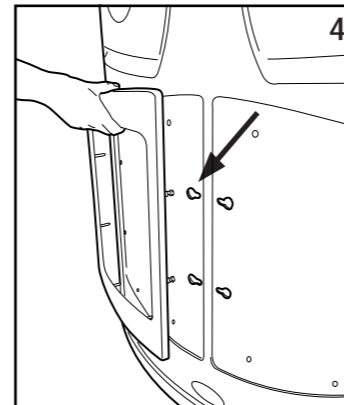

4 When positioning the rear poster frame, firstly attach inner fixings by locating washers through the key hole slots. Secure frame by tightening wingnuts.

NEXUS™ 200

Operating Manual

Emptying/Replacing Ashtray Liner

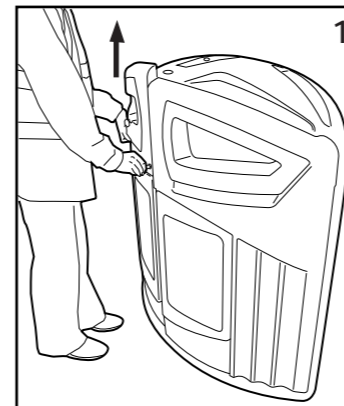

1 Open both doors as detailed previously. ('Opening Bin' section)

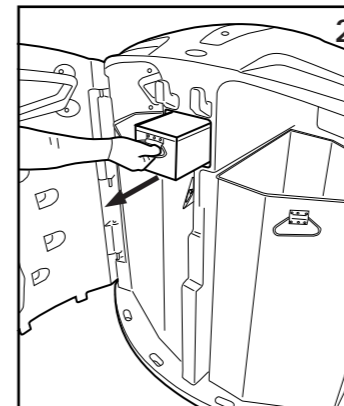

2 Using the handle, slide the ashtray liner out. Use other hand to support the liner.



3 Empty contents of the liner.

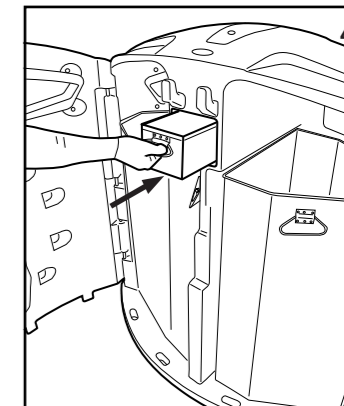

4 Slide ash liner back into the bin compartment making sure the handle is facing towards you.

Inserting Aperture Blanking Panel

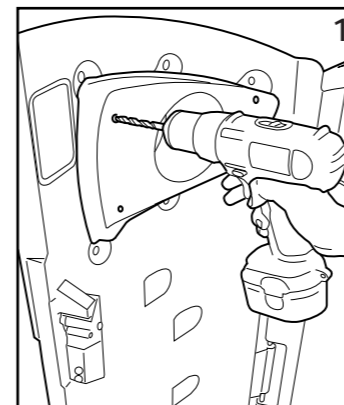

1 On inside face of aperture panel, drill 4 off 3mm holes. The four off raised bosses on the rear of the panel indicate hole positions.

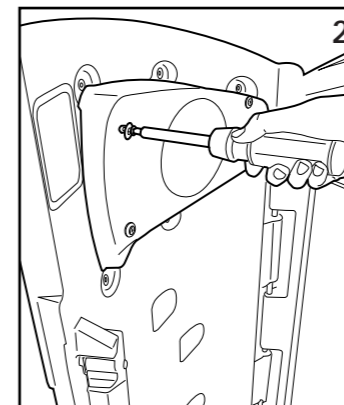

2 Fix the washers and screws provided into the drilled holes. Do not overtighten.

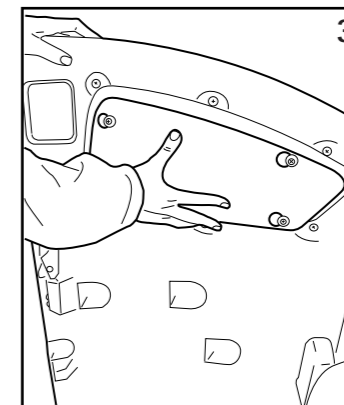

3 Place blanking panel over washers and slide panel horizontally so that it locates in key shaped holes.

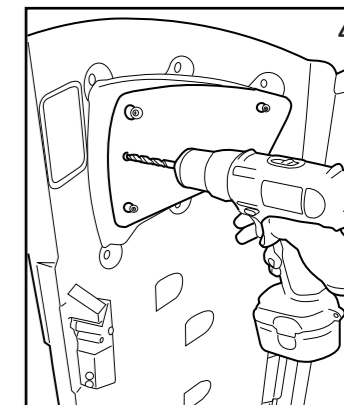

4 Drill 3mm hole through remaining fixing point on blanking panel.

Inserting Base Trays

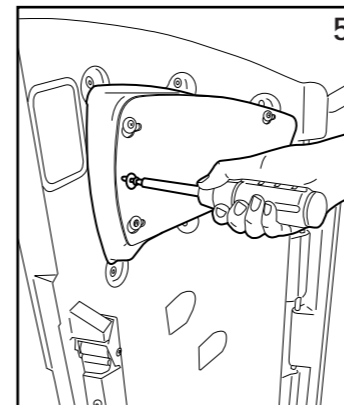

5 Fix panel securely in place using the washer and screw provided.

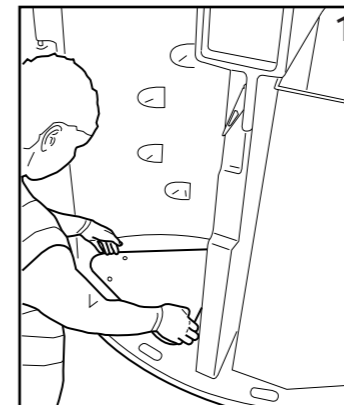

1 Open doors and place tray into recess within base of bin.

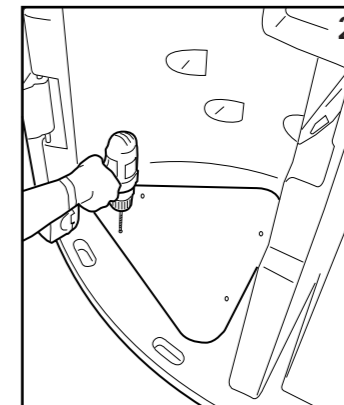

2 Drill 4 off 3mm holes through base tray holes into the base of the bin.

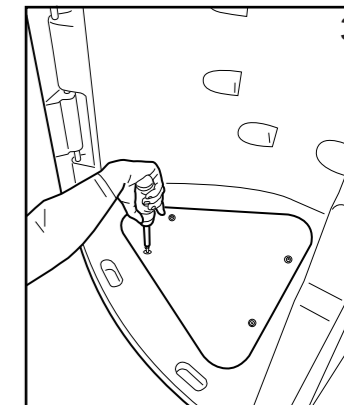

3 Fix tray into place using washers and screws provided.